



Price
£375,000

Freehold

3x  1x  2x 

**David Avenue,
Wickford, Essex, SS11**

OVER 60?

Secure this property
for up to **59% less!**

 **DOUGLAS
ALLEN**
Helping you move forwards



Main features

- Extended garage
- Driveway providing off street parking
- Through lounge/dining area
- An excellent opportunity for a family or as a first time purchase
- Viewings highly recommended

Accommodation

GROUND FLOOR

Entrance Door

Entrance Hallway

Lounge : 12'1 x 11'2 (3.69m x 3.41m)

Dining Area: 12'5 x 9'1 (3.79m x 2.77m)

Kitchen: 12'5 x 8'10 (3.79m x 2.69m)

FIRST FLOOR

Landing

Bedroom 1: 12'9 x 10'4 (3.89m x 3.15m)

Bedroom 2: 11'11 x 11'5 (3.63m x 3.48m)

Bedroom 3: 8'10 x 6'11 (2.69m x 2.11m)

Bathroom

SECOND FLOOR

Loft Area: 17'6 x 12'1 (5.34m x 3.69m)

OUTSIDE

Rear Garden

Garage

Off Street Parking

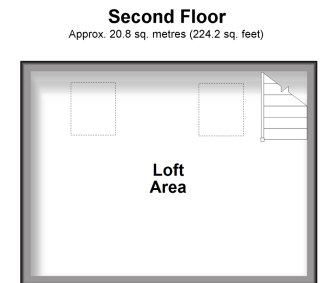
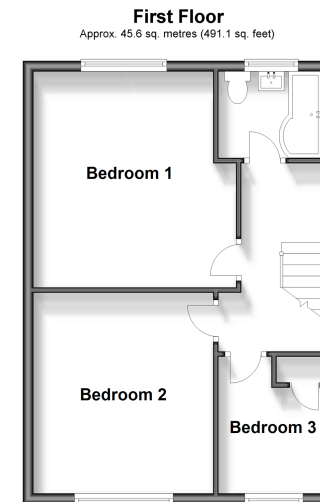
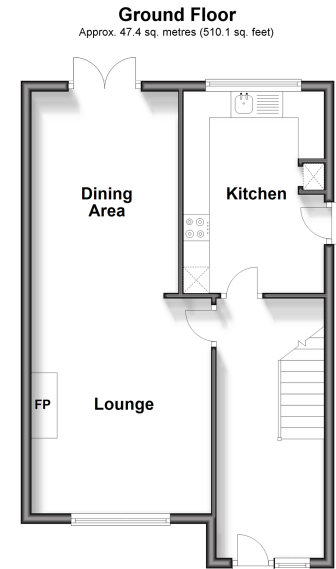

Call Wickford - 01268 561287 ■ douglasallen.co.uk

- Legal advice should be taken to verify fixtures/fittings, planning, alterations and/or lease details
- Appliances & services are untested, dimensions are approximate and floor plans are not to scale
- Through a Homewise Home For Life Plan people aged 60+ can secure this property for up to 59% less, by purchasing a Lifetime Lease.



53412808/20240313/GM/AH