



**Price**

**£170,000**

**Leasehold**

1x  1x  1x 

**Arundel Road, Wickford,  
Essex, SS11**

**OVER 60?**

Secure this property  
for up to **59% less!**

 **DOUGLAS  
ALLEN**  
Helping you move forwards





## Main features

- Large one bedroom apartment
- Attractive kitchen
- Long lease remaining
- Double glazed windows and gas central heating
- Within close proximity to Wickford mainline Railway Station.

## Accommodation

### GROUND FLOOR

Communal Entrance Hallway  
Communal Stairs

### FIRST FLOOR

Entrance Door  
Entrance Hallway  
Kitchen: 8'3 x 7'8 (2.52m x 2.34m)  
Lounge/Dining Room: 14'8 x 11'3 (4.47m x 3.43m)  
Bedroom: 12'2 x 9'11 (3.71m x 3.02m)  
Bathroom

### OUTSIDE

Communal Gated Parking

## First Floor

Approx. 46.4 sq. metres (499.3 sq. feet)

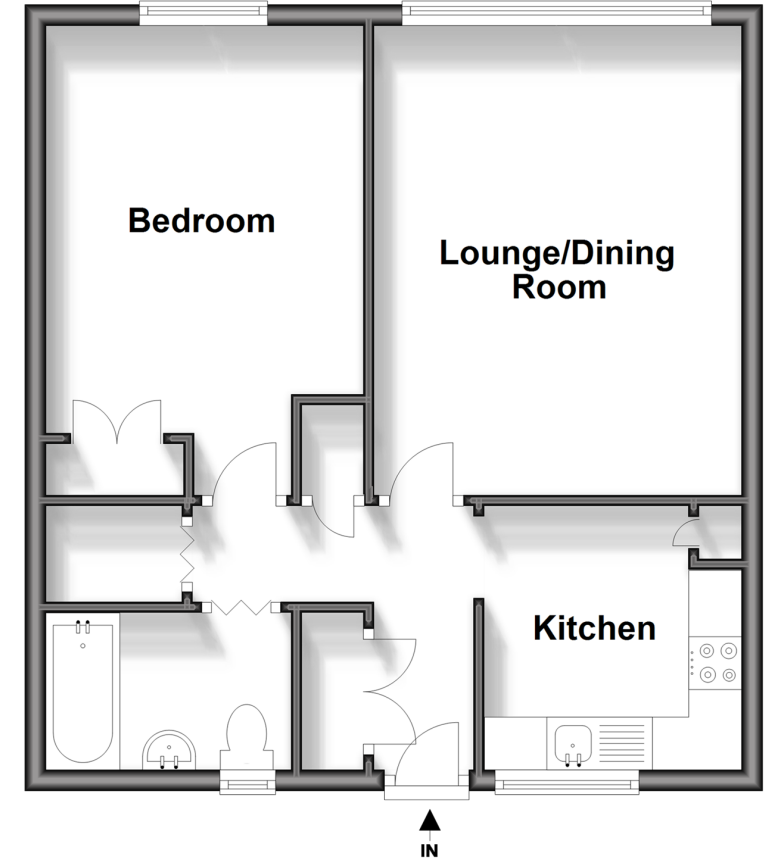

**Call Wickford - 01268 561287 ■ [douglasallen.co.uk](http://douglasallen.co.uk)**

- Legal advice should be taken to verify fixtures/fittings, planning, alterations and/or lease details
- Appliances & services are untested, dimensions are approximate and floor plans are not to scale
- Through a Homewise Home For Life Plan people aged 60+ can secure this property for up to 59% less, by purchasing a Lifetime Lease.



53412762/20240118/AH/AH