



Price

£115,000

Leasehold

1x  1x  1x 

**Homeholly House,
Church End Lane,
Runwell, Wickford,
Essex, SS11**

OVER 60?

Secure this property
for up to **59% less!**

 **DOUGLAS
ALLEN**
Helping you move forwards



Main features

- Popular Over 60's development
- Part time warden assisted
- Guest room available for relatives on site
- Communal lounge as well as a launderette room on site
- Service charge includes water rates and building insurance

Accommodation

GROUND FLOOR

Communal Entrance Hallway

Entrance Door

Entrance Hallway

Lounge/Diner: 17'6 x 10'7 (5.34m x 3.23m)

Kitchen: 7'3 x 5'5 (2.21m x 1.65m)

Bedroom : 14'1 x 8'7 (4.30m x 2.62m)

Bathroom

OUTSIDE

Communal Grounds

Ground Floor

Approx. 43.9 sq. metres (472.6 sq. feet)

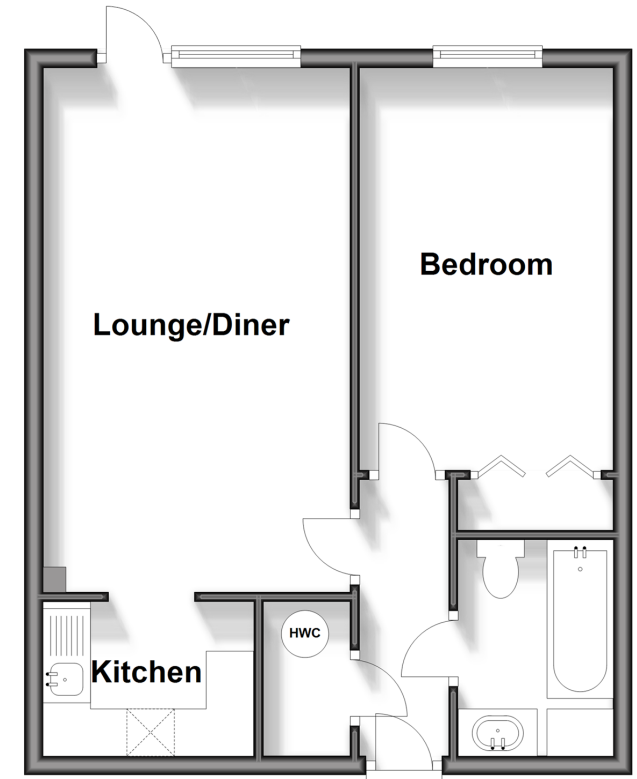

Call Wickford - 01268 561287 ■ douglasallen.co.uk

- Legal advice should be taken to verify fixtures/fittings, planning, alterations and/or lease details
- Appliances & services are untested, dimensions are approximate and floor plans are not to scale
- Through a Homewise Home For Life Plan people aged 60+ can secure this property for up to 59% less, by purchasing a Lifetime Lease.



53412714/20240122/GM/AH