



**Price**

**£350,000**

**Freehold**

2x  1x  1x 

**Windsor Gardens,  
Wickford, Essex, SS11**

**OVER 60?**

Secure this property  
for up to **59% less!**



**Video Tour available**



**DOUGLAS  
ALLEN**

Helping you move forwards





## Main features

- Attractive semi detached bungalow.
- Offered with no onward chain.
- Re-fitted kitchen leading to additional conservatory.
- Within close proximity to Wickford High Street and mainline Railway Station.

## Accommodation

### GROUND FLOOR

#### Entrance Hall

Kitchen: 9'2 x 7'7 (2.80m x 2.31m)

Lounge/Diner: 14'10 x 11'11 (4.52m x 3.63m)

Conservatory: 22'8 x 5'11 (6.91m x 1.80m)

Bedroom 1 : 11'11 x 9'10 (3.63m x 3.00m)

Bedroom 2: 9'11 x 7'9 (3.02m x 2.36m)

#### Shower Room

### OUTSIDE

#### Rear Garden

#### Off Street Parking

## Ground Floor

Approx. 49.7 sq. metres (535.1 sq. feet)

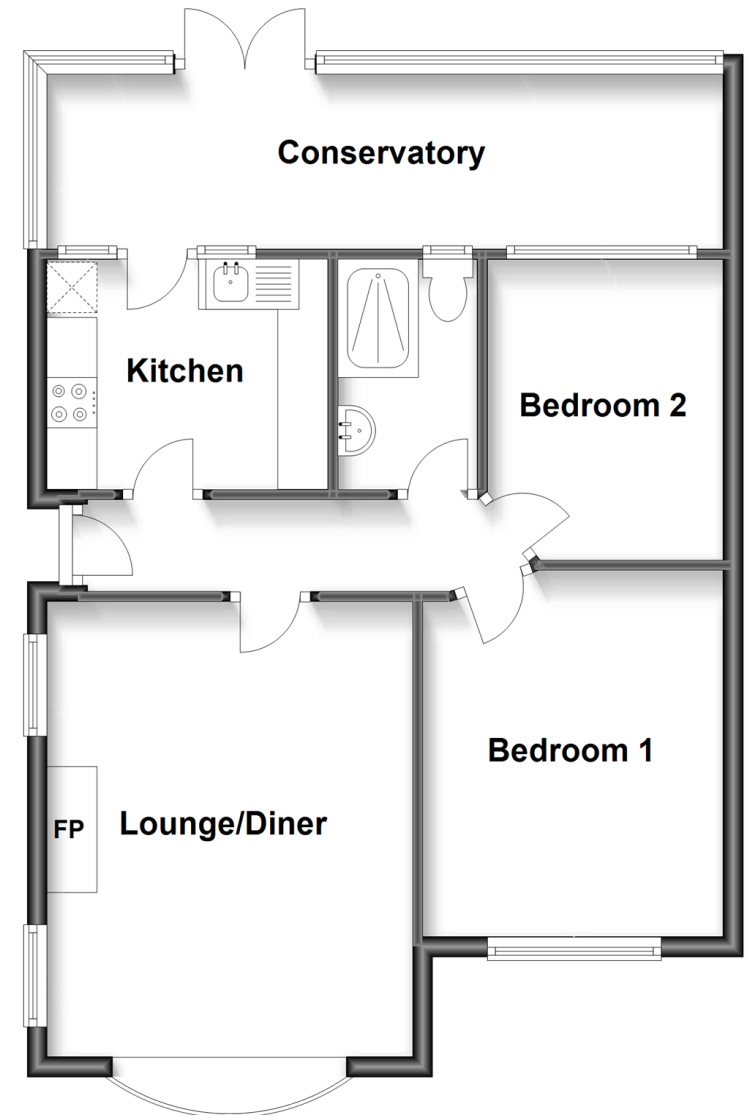

**Call Wickford - 01268 561287 ■ [douglasallen.co.uk](http://douglasallen.co.uk)**

- Legal advice should be taken to verify fixtures/fittings, planning, alterations and/or lease details
- Appliances & services are untested, dimensions are approximate and floor plans are not to scale
- Through a Homewise Home For Life Plan people aged 60+ can secure this property for up to 59% less, by purchasing a Lifetime Lease.



53412507/20230110/GM/AH