



Guide Price
£180,000

Leasehold

1x  1x  1x 

**Ennerdale Court,
Cambridge Road,
Wanstead, E11**

OVER 60?

Secure this property
for up to **59% less!**



Video Tour available



**DOUGLAS
ALLEN**

Helping you move forwards



Main features

- 1 bed first floor retirement flat in good condition
- No onward chain
- Close to Wanstead Station and High Street
- Independent living for over 55 year olds
- Secured entrance & lift

Accommodation

FIRST FLOOR

Hallway: 10'4 x 3'3 (3.15m x 0.99m)
 Lounge/Diner: 18'0 x 10'5 (5.49m x 3.18m)
 Kitchen: 7'9 x 6'9 (2.36m x 2.06m)
 Bedroom: 14'4 x 9'0 (4.37m x 2.75m)
 Bathroom: 7'3 x 5'1 (2.21m x 1.55m)

OUTSIDE

Communal Gardens
 Communal Parking

First Floor

Approx. 46.0 sq. metres (495.5 sq. feet)

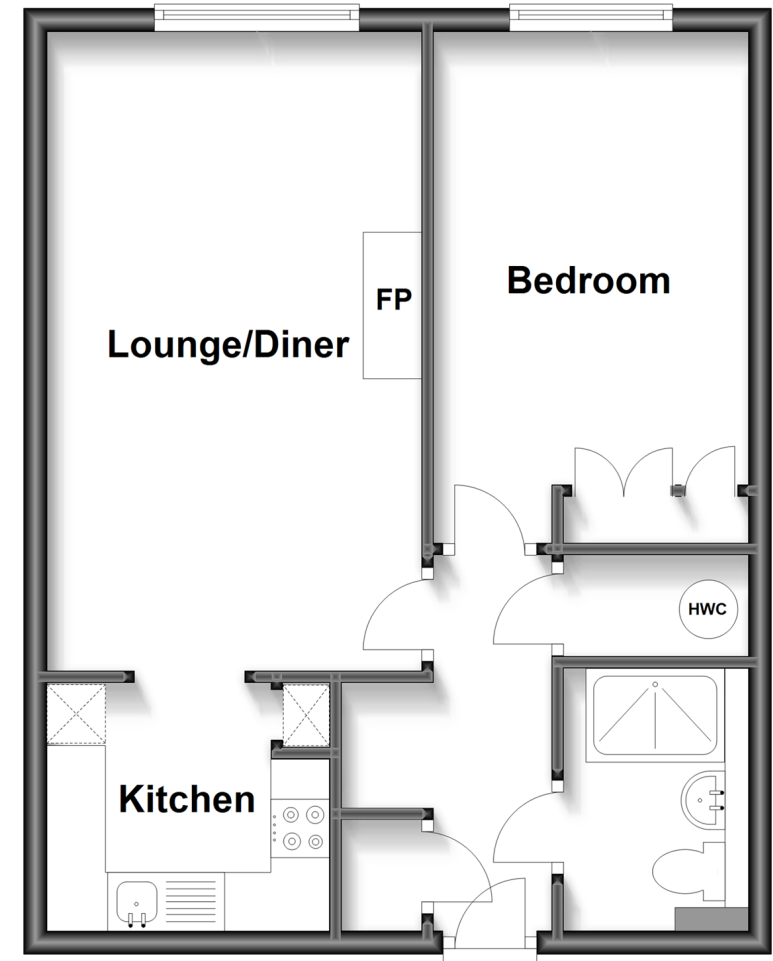

Call Wanstead - 020 8530 3741 ■ douglasallen.co.uk

- A private rental licensing scheme applies to some properties in this area, please contact us before proceeding
- Legal advice should be taken to verify fixtures/fittings, planning, alterations and/or lease details
- Appliances & services are untested, dimensions are approximate and floor plans are not to scale
- Through a Homewise Home For Life Plan people aged 60+ can secure this property for up to 59% less, by purchasing a Lifetime Lease.



53212200/20230324/RP/RP