



Offers In Excess Of £250,000 Leasehold

2x  1x  1x 

Burnside Court, South
Street, Romford, Essex,
RM1

OVER 60?

Secure this property
for up to **59% less!**

 **DOUGLAS
ALLEN**
Helping you move forwards



Main features

- Two bedroom ground floor flat with no onward chain
- Allocated parking space & communal garden
- New boiler installed in 2021
- Situated within close proximity to Romford Station & Town Centre

Accommodation

GROUND FLOOR

Hallway

Bathroom

Bedroom 2: 13'0 x 8'6 at widest point (3.97m x 2.59m)

Bedroom 1: 14'4 x 9'7 (4.37m x 2.92m)

Lounge/Diner: 14'4 x 12'8 (4.37m x 3.86m)

Kitchen: 8'0 x 6'9 (2.44m x 2.06m)

OUTSIDE

Allocated Parking Space

Communal Garden

Ground Floor

Approx. 56.4 sq. metres (606.6 sq. feet)

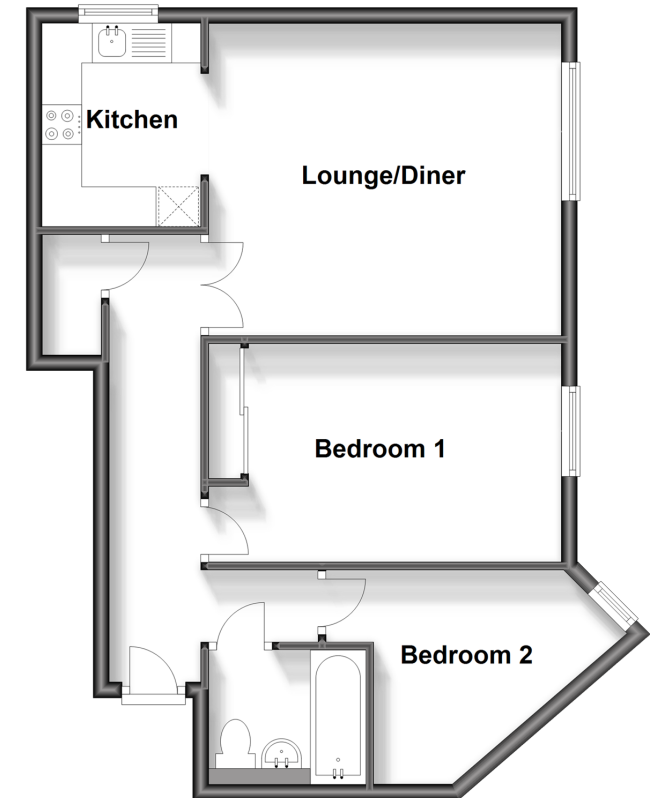

Call Hornchurch - 01708 437777 ■ douglasallen.co.uk

- A private rental licensing scheme applies to some properties in this area, please contact us before proceeding
- Legal advice should be taken to verify fixtures/fittings, planning, alterations and/or lease details
- Appliances & services are untested, dimensions are approximate and floor plans are not to scale
- Through a Homewise Home For Life Plan people aged 60+ can secure this property for up to 59% less, by purchasing a Lifetime Lease.



51915728/20230630/CC1/DT