



**Price**  
**£350,000**

**Leasehold**

2x  2x  1x 

**Fullerton Avenue,  
Dagenham**

**OVER 60?**

Secure this property  
for up to **59% less!**

 **DOUGLAS  
ALLEN**  
Helping you move forwards





## Main features

- Purpose built flat with own balcony
- Bright and spacious throughout
- Shops and amenities within walking distance
- Close to Chadwell Heath Station and Goodmayes Station
- Bus links to Westfield Stratford

## Accommodation

### FIRST FLOOR

Hallway  
 Lounge/Dining Area: 15'9 x 12'9 (4.80m x 3.89m)  
 Kitchen: 10'5 x 9'1 (3.18m x 2.77m)  
 Bedroom 1: 12'7 x 10'7 (3.84m x 3.23m)  
 En-Suite  
 Bedroom 2: 13'9 x 9'9 (4.19m x 2.97m)  
 Bathroom  
 Balcony

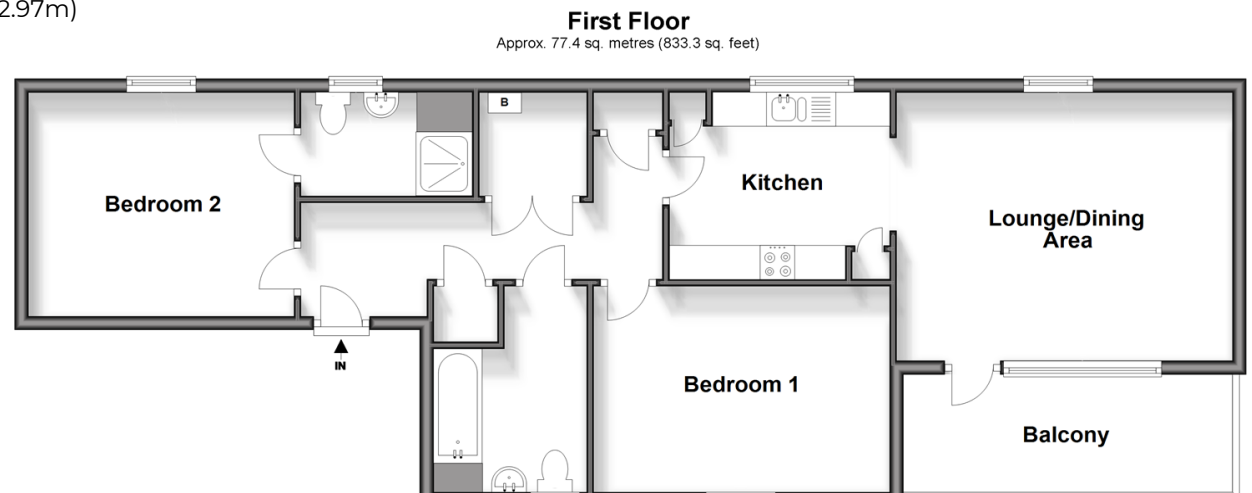

**Call Chadwell Heath - 020 8597 0043 ■ [douglasallen.co.uk](http://douglasallen.co.uk)**

- A private rental licensing scheme applies to some properties in this area, please contact us before proceeding
- Appliances & services are untested, dimensions are approximate and floor plans are not to scale

- Legal advice should be taken to verify fixtures/fittings, planning, alterations and/or lease details
- Through a Homewise Home For Life Plan people aged 60+ can secure this property for up to 59% less, by purchasing a Lifetime Lease.

