



**Price**

**£230,000**

**Leasehold**

2x  1x  1x 

**Millhaven Close,  
Romford, Essex, RM6**

**OVER 60?**

Secure this property  
for up to **59% less!**



**DOUGLAS  
ALLEN**

Helping you move forwards



## Main features

- Purpose built flat situated within the popular Redbridge Borough
- Allocated parking
- Walking distance to local park, ideal for outdoor activities
- Bus & road links to Chadwell Heath station & Ilford High Rd
- Ideal purchase for first time buyers or buy-to-let investors

## Accommodation

### GROUND FLOOR

Entrance Hall

Lounge: 15'7 x 11'3 (4.75m x 3.43m)

Kitchen: 8'6 x 8'5 (2.59m x 2.57m)

Bedroom 1: 13'0 x 9'3 (3.97m x 2.82m)

Bedroom 2: 9'1 x 6'9 (2.77m x 2.06m)

Bathroom

### OUTSIDE

Off Street Parking

### Ground Floor

Approx. 49.8 sq. metres (536.0 sq. feet)

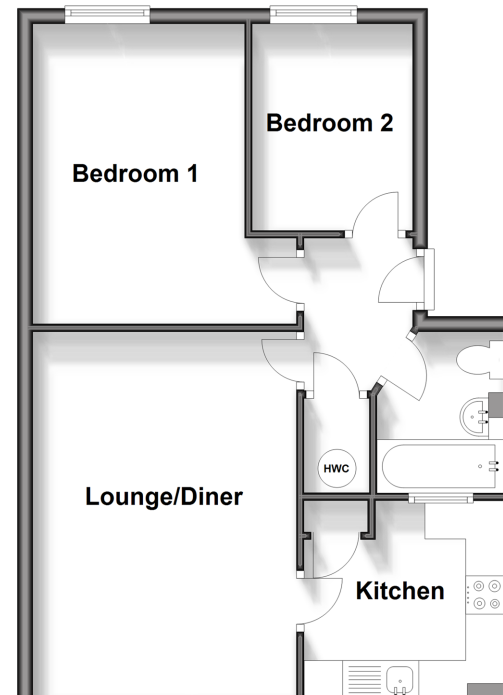

**Call Chadwell Heath - 020 8597 0043 ■ [douglasallen.co.uk](http://douglasallen.co.uk)**

- A private rental licensing scheme applies to some properties in this area, please contact us before proceeding
- Appliances & services are untested, dimensions are approximate and floor plans are not to scale

- Legal advice should be taken to verify fixtures/fittings, planning, alterations and/or lease details
- Through a Homewise Home For Life Plan people aged 60+ can secure this property for up to 59% less, by purchasing a Lifetime Lease.