



OVER 60?

Secure this property
for up to **59% less!**

Price

£425,000

Freehold

3x  1x  1x 

**Warrington Square,
Billericay, Essex, CM12**

 **DOUGLAS
ALLEN**
Helping you move forwards



Main features

- Sought after location
- Situated in a cul-de-sac and offered with no onward chain
- 0.6 miles to Billericay mainline station and High street
- Close to local shops and schools
- Spacious lounge with feature fireplace
- Good size rear garden

Accommodation

GROUND FLOOR

Porch

Lounge: 14'7 x 14'7 (4.45m x 4.45m)

Kitchen/Dining Room: 14'7 x 9'5 (4.45m x 2.87m)

FIRST FLOOR

Landing

Bedroom 1: 14'7 (4.45m) narrowing to 11'4 (3.46m) x 8'5 (2.57m)

Bedroom 2: 9'5 x 7'5 (2.87m x 2.26m)

Bedroom 3: 8'5 x 5'9 (2.57m x 1.75m)

Bathroom: 6'8 x 5'5 (2.03m x 1.65m)

OUTSIDE

Front and Rear Gardens

Garage

Off Street Parking

Call Billericay - 01277 631377 ■ douglasallen.co.uk

- Legal advice should be taken to verify fixtures/fittings, planning, alterations and/or lease details
- Appliances & services are untested, dimensions are approximate and floor plans are not to scale
- Through a Homewise Home For Life Plan people aged 60+ can secure this property for up to 59% less, by purchasing a Lifetime Lease.

Ground Floor

Approx. 34.6 sq. metres (372.1 sq. feet)

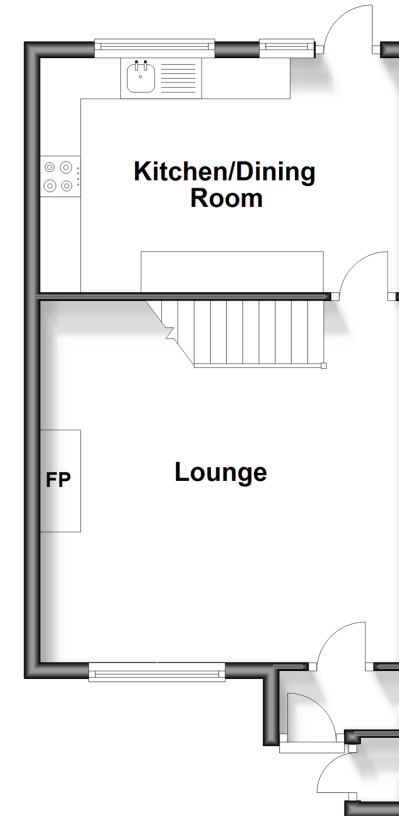

First Floor

Approx. 32.9 sq. metres (354.3 sq. feet)

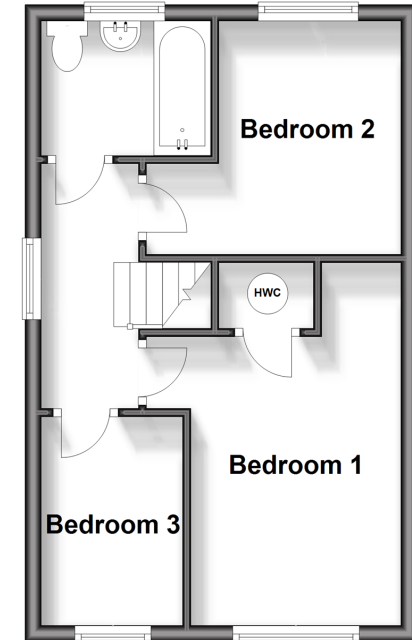

50313173/20240424/FL/BH