



Price

£285,000

Leasehold

2x  1x  1x 

**Crowsheath Estate,
Hawkswood Road,
Downham, Billericay,
Essex, CM11**



Main features

- Immaculately presented 2 bedroom park home
- Pet friendly park designed for over 40's
- Private parking for 4 cars
- Dressing room and en-suite shower room to bedroom 1
- Stunning kitchen and bathroom
- Great size lounge
- Electric gated entrance
- Mortgage purchases unavailable
- Part exchange or loan from developer available

Accommodation

GROUND FLOOR

Hallway
 Lounge: 21'9 x 10'8 (6.63m x 3.25m)
 Kitchen/Diner: 19'2 x 8'0 (5.85m x 2.44m)
 Utility Room: 6'2 x 6'1 (1.88m x 1.86m)
 Study
 Bedroom 1: 12'4 x 9'7 (3.76m x 2.92m)
 Dressing Room
 En-Suite Shower Room: 7'1 x 4'9 (2.16m x 1.45m)
 Bedroom 2: 9'8 x 9'3 (2.95m x 2.82m)
 Bathroom: 8'8 x 6'9 (2.64m x 2.06m)

OUTSIDE

Allocated Parking

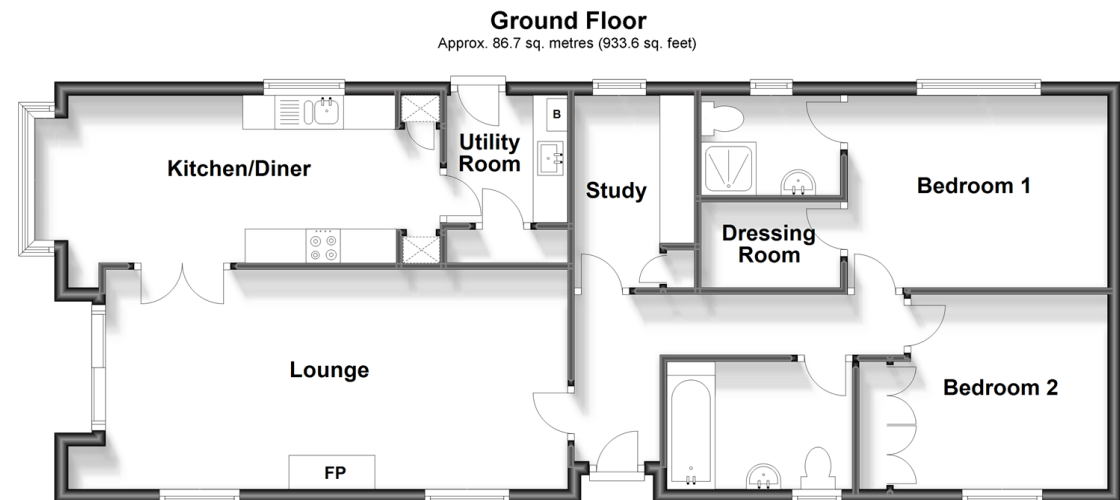

Call Billericay - 01277 631377 ■ douglasallen.co.uk

- If buying to let, the energy rating will need to be improved to at least 'E' rating before you can let the property
- Appliances & services are untested, dimensions are approximate and floor plans are not to scale

■ Legal advice should be taken to verify fixtures/fittings, planning, alterations and/or lease details

