



Price

£1,250,000

Freehold

4x  2x  2x 

**Sudbury Road,
Downham, Billericay,
Essex CM11**

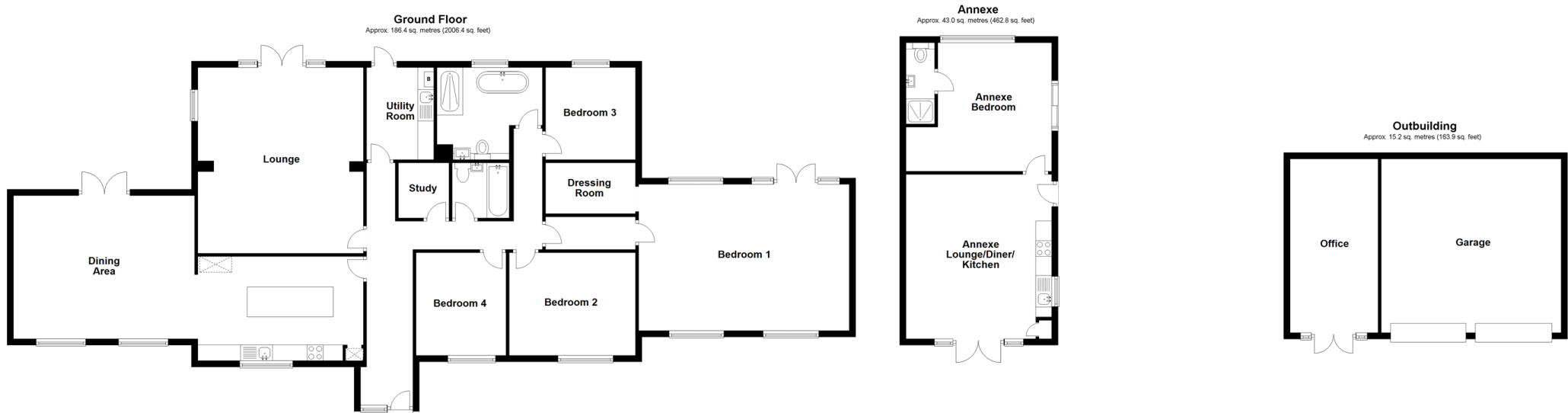

Accommodation

GROUND FLOOR

Hallway
 Lounge: 21'4 x 17'0 (6.51m x 5.19m)
 Kitchen: 17'0 x 10'9 (5.19m x 3.28m)
 Dining Area: 18'8 x 14'11 (5.69m x 4.55m)
 Utility Room: 9'7 x 6'11 (2.92m x 2.11m)
 Bathroom: 5'7 x 5'6 (1.70m x 1.68m)

Study: 5'8 x 5'6 (1.73m x 1.68m)
 Bedroom 1: 21'6 x 15'3 (6.56m x 4.65m)
 Dressing Room: 9'9 x 5'3 (2.97m x 1.60m)
 Bedroom 2: 12'11 x 10'8 (3.94m x 3.25m)
 Bedroom 3: 10'8 x 9'9 (3.25m x 2.97m)
 Bedroom 4: 9'6 x 9'5 (2.90m x 2.87m)
 Shower Room: 10'10 x 9'9 (3.30m x 2.97m)

OUTSIDE

Front and Rear Gardens
 Large Driveway

OUTBUILDING

Office: 18'5 x 9'0 (5.62m x 2.75m)
 Double Garage

ANNEXE

Lounge/Diner/Kitchen: 17'2 x 16'10 (5.24m x 5.13m)
 Bedroom: 13'4 x 11'4 (4.07m x 3.46m)
 Annexe Shower Room: 8'5 x 2'11 (2.57m x 0.89m)



Main features

- Detached bungalow with a 1 bedroom self contained annex
- Situated on a good size plot
- Large lounge and fantastic sized dining area
- Modern kitchen and utility room
- No onward chain
- Beautiful frontage and rear garden
- Dressing room to the master bedroom
- Separate 18ft office



Nearest Schools

Primary Schools: Downham C of E Voluntary Controlled Primary 1.2 miles, Runwell Community Primary 1.4 miles, Wickford Junior School 1.8 miles

Secondary Schools: The Bromfords School 2.3 miles,



Transport Information

Train Stations: Wickford 1.7 miles, Battlesbridge 2.8 miles, Billericay 3.7 miles



Address

Sudbury Road, Downham, Billericay, Essex CM11



Directions

For directions to this property please contact us.





Call Billericay Branch 01277 631377 ■ douglasallen.co.uk



■ Legal advice should be taken to verify fixtures/fittings, planning, alterations and/or lease details ■ Appliances & services are untested, dimensions are approximate and floor plans are not to scale



50312299/20220627/AV/DL