



**Price**  
**£425,000**

**Freehold**

2x  1x  1x 

**Caterham Avenue,  
Ilford, Essex, IG5**



Video Tour available



**DOUGLAS  
ALLEN**

Helping you move forwards





## Main features

- Semi-detached bungalow
- Garage and drive with disabled access to house
- Extendable loft (STPP)
- Front and rear garden
- Great schools: Gilbert Colvin, Clore Tikva & Caterham HS
- Close to Barkingside High Street, & Central Line, M11, A406, & A12

## Accommodation

### GROUND FLOOR

Porch  
 Entrance hall  
 Family room : 16'5 x 9'7 (5.01m x 2.92m)  
 Lounge : 19'1 x 10'4 (5.82m x 3.15m)  
 Kitchen : 10'2 x 6'2 (3.10m x 1.88m)  
 Shower room : 7'1 x 5'5 (2.16m x 1.65m)  
 Bedroom 1: 16'3 x 8'1 (4.96m x 2.47m)  
 Bedroom 2: 11'4 x 6'5 (3.46m x 1.96m)

### OUTSIDE

Rear garden  
 Off street parking

## Ground Floor

Approx. 63.1 sq. metres (679.0 sq. feet)

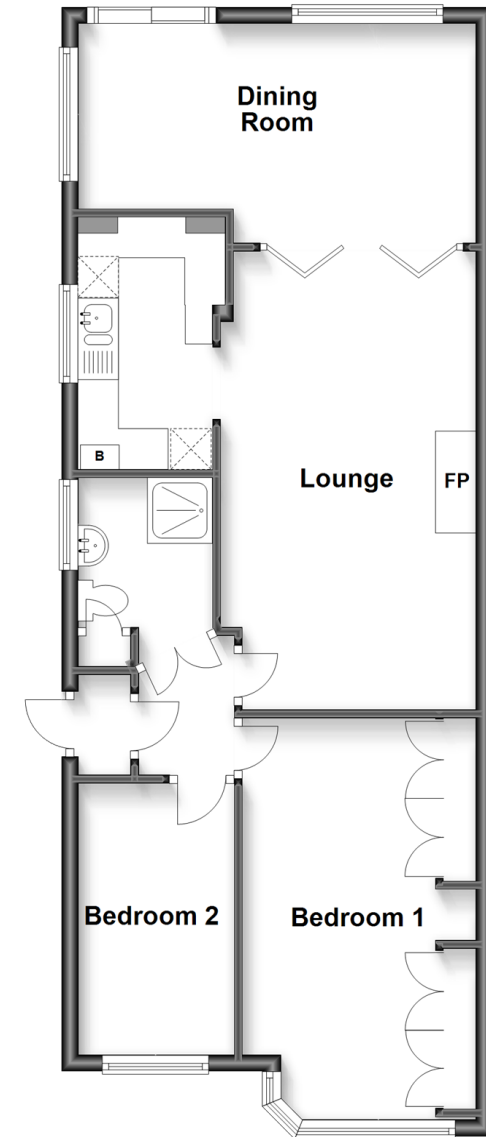

**Call Barkingside - 020 8551 4025 ■ [douglasallen.co.uk](http://douglasallen.co.uk)**

- A private rental licensing scheme applies to some properties in this area, please contact us before proceeding
- Legal advice should be taken to verify fixtures/fittings, planning, alterations and/or lease details
- Appliances & services are untested, dimensions are approximate and floor plans are not to scale



50216006/20230206/AD/AD